

Luxury Yacht Deck Plans

Emerald Kaia

- DECK 7 SKY DECK
- DECK 6 POOL DECK
- DECK 5 PANORAMA DECK
- DECK 4 OBSERVATION DECK
- DECK 3 EMERALD DECK
- DECK 2 WELLNESS DECK

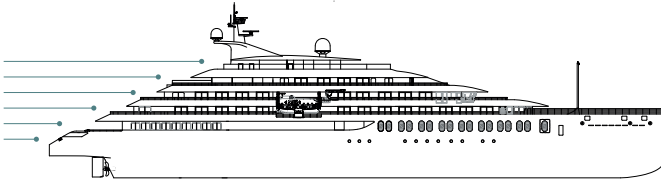

- Launching 2026
- Length: 120m (393.7ft)
- Guests: 128
- Cabins: 64
- Crew Members: 92

- 1 Spa Pool
- 2 Sky Bar
- 3 Lifts
- 4 Sky Deck Cabanas
- 5 Aqua Café
- 6 Aqua Pool
- 7 Navigation Bridge
- 8 Life Boats
- 9 Spa Pool
- 10 Observation Sun Deck
- 11 Observation Lounge
- 12 Self-Service Laundry
- 13 Amici Bar & Lounge
- 14 Reception
- 15 Boutique
- 16 Night Market Grill
- 17 La Cucina Dining
- 18 La Cucina Terrace
- 19 Medical Centre
- 20 Elements Spa
- 21 Sauna
- 22 Infrared Sauna
- 23 Hairdresser
- 24 Tender Boat
- 25 Zodiacs
- 26 Gym
- 27 Marina Lounge
- 28 Marina Deck

Cabin Categories

Pool Deck – 6		Size (m ²)
SA	Owner's Suite	130.8m ²
S	Deluxe Balcony Suite	44.3m ²
AB	Balcony Suite	31.6m ²
Panorama Deck – 5		Size (m ²)
T	Terrace Suite	77.2m ²
A	Balcony Suite	31.6m ²
Observation Deck – 4		Size (m ²)
Y	Yacht Suite	81.7m ²
B	Balcony Suite	31.6m ²
Emerald Deck – 3		Size (m ²)
D	Oceanview Stateroom	20.6m ² – 23.2m ²

Interconnecting Suites are available - enquire for details

Important Information: Deck plans are an indication only and are subject to variation. Cabin sizes include terrace areas.

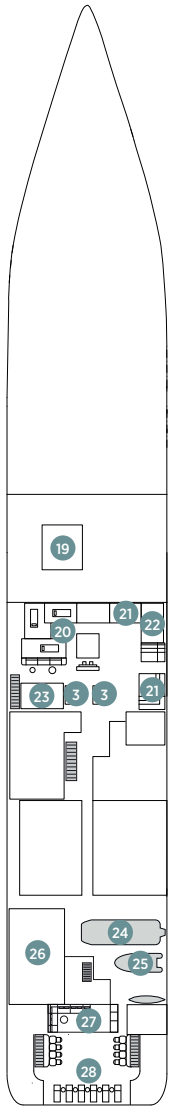

Deck 2
Wellness Deck

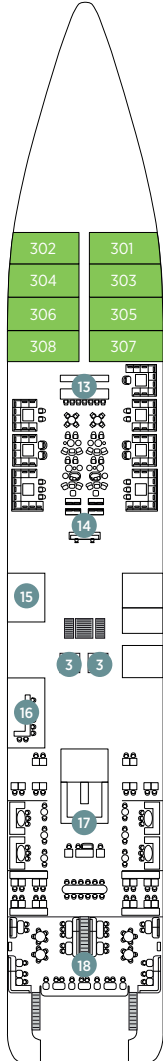

Deck 3
Emerald Deck

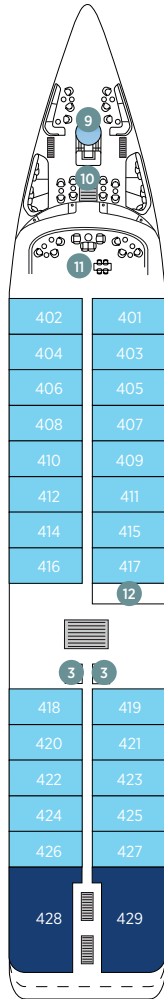

Deck 4
Observation Deck

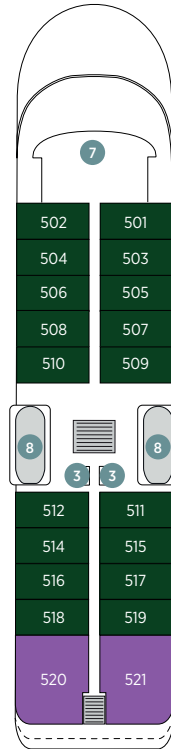

Deck 5
Panorama Deck

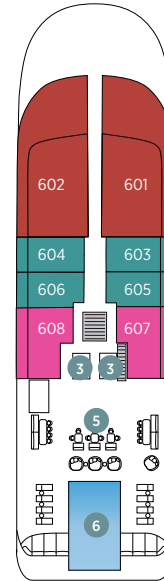

Deck 6
Pool Deck

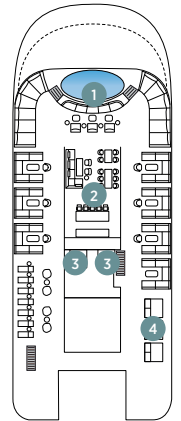

Deck 7
Sky Deck